



Our Common Future

Hannover · Essen
2 - 6 November 2010

Programme

The interdisciplinary congress
for a cross-generational
dialogue about issues of our
common future

Presented by Volkswagen Foundation, Deutsche Messe and
Stiftung Mercator in cooperation with the City of Hannover
and the European Capital of Culture RUHR.2010.

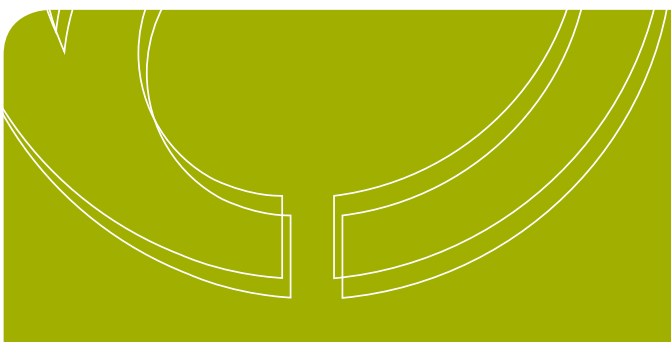

- 2 Contents
- 3 Words of Welcome
- 4 Conference Opening and Evening Programme

Programme

Hannover 3 November 2010

- 6 **Session 1: Global Health and Molecular Medicine I**
Scientific Advisor: Axel Haverich
- 7 **Session 2: Future Technologies I: Communication**
Scientific Advisor: Wolfgang Wahlster
- 8 **Session 3: Economic Development for Global Inclusion**
Scientific Advisor: Stephan Klasen

Hannover 4 November 2010

- 9 **Session 4: Climate Change and Energy I**
Scientific Advisor: Hans Joachim Schellnhuber
- 10 **Session 5: Future Technologies II: Mobility**
Scientific Advisor: Andreas Knie
- 11 **Session 6: Human Rights - Global Culture - International Institutions**
Scientific Advisors: Dieter Grimm, Jutta Limbach

Hannover
Convention Center
Deutsche Messe

Essen 5 November 2010

- 12 **Session 7: Climate Change and Energy II**
Scientific Advisor: Reinhard Hüttl
- 13 **Session 8: Future Technologies III: The Factory of the Future**
Scientific Advisor: Fritz Klocke
- 14 **Session 9: Migration and Integration: Global Tensions - Local Responses**
Scientific Advisors: Klaus J. Bade, Ludger Pries

Essen 6 November 2010

- 15 **Session 10: Global Health and Molecular Medicine II**
Scientific Advisor: Karl Lenhard Rudolph
- 16 **Session 11: Metropolis**
Scientific Advisor: Volker Kreibich
- 17 **Session 12: Religion and Values**
Scientific Advisor: Hans Joas

Essen
Philharmonic
Concert Hall Essen

Research Areas and Scientific Advisors

- 18 Climate Change and Energy
- 19 Future Technologies
- 20 Economic and Urban Development
- 21 Global Health and Molecular Medicine
- 22 Human Rights and Global Values

23 Young Researchers (GYF and OCF Fellows)

General Information

- 24 Hosts
- 26 Hannover: Arrival, Venue and General Information
- 27 Map of Convention Center Hannover
- 28 Essen: Arrival, Venue and General Information
- 29 Map of Philharmonic Concert Hall Essen
- 30 Contacts



Dear Participants,

Almost 40 years ago, under the auspices of the Club of Rome, a study on the future well-being of humanity was prepared with the financial support of the Volkswagen Foundation. The report, which was published under the title "Limits to Growth" in 1972, explored how exponential growth interacts with finite resources. The authors predicted that if growth continued unchecked, the Earth's ecological systems would be overwhelmed within a century. They investigated five global trends - accelerating industrialization, rapid population growth, widespread malnutrition, depletion of non-renewable resources, and a deteriorating environment - which are still pertinent today.

15 years later, the World Commission on Environment and Development stated in its report "Our Common Future": "Humanity has the ability to make development sustainable to ensure that it meets the needs of the present without compromising the ability of future generations to meet their own needs." So far, however, humanity has largely failed to demonstrate this ability - thus endangering its own future.

The Brundtland Commission had been called upon by the General Assembly of the United Nations to formulate a global agenda for change and to propose strategies for achieving sustainable development by the year 2000 and beyond. Gro Harlem Brundtland, the Commission's Chairperson, saw this call as "a clear demonstration of the widespread feeling of frustration and inadequacy in the international community about our own ability to address the vital global issues and deal effectively with them".

Though the Commissioners' suggestions on how to address these issues did not go entirely unheard, our record on moving towards sustainable development still remains very poor in 2010 - and the need to deal effectively with an ever increasing number of global challenges is even more urgent.

Since the late 1980s, we have been experiencing social, environmental, cultural and technological change at an unprecedented pace. In today's globalized world we are faced with enormous challenges posed by climate change, economic crises, inefficient or poorly developed health systems, migration and quite diverse demographic developments. These changes and challenges make it imperative to rethink traditional approaches,

review respective modes of operation and subsequently develop new and sustainable solutions for tomorrow's world.

In staging the conference "Our Common Future", the aim of the Volkswagen Foundation, Deutsche Messe and Stiftung Mercator is to provide a platform for leading intellectuals, business-people and politicians, as well as young researchers, to enter into a dialogue in order to identify the major challenges which lie ahead, to present different perspectives on global issues and, last but not least, to suggest solutions for the way forward. The conference resumes the discussion of issues central to our common future raised during the Expo 2000 in Hannover. In Essen, it is the highlight of the RUHR.2010 European Capital of Culture academic programme.

The many questions to be addressed include the following: How can we turn the challenges our world is facing into opportunities for individuals and organizations, as well as for entire societies and the world at large? What are the limits and limitations of political and economic powers? Is it perhaps already too late to achieve sustainable development? What impact will new scientific and technological achievements have on food production, population growth and the environment? Which role do we foresee for international institutions, religious movements and non-governmental organizations in an increasingly interdependent world?

The conference "Our Common Future" wishes to facilitate an exchange of ideas between all those interested in and capable of contributing to a more sustainable future for our planet. We look forward to four days of interdisciplinary debate on pressing issues such as global health, climate change, future technologies, economic and urban development, migration and human rights.

We are delighted that you are attending our conference and cordially invite you to engage in an exciting dialogue about promising ideas to jointly and sustainably shape our common future.

Wilhelm Krull
Secretary General
Volkswagen Foundation

Wolfram v. Fritsch
Chairman of the Board
Deutsche Messe

Bernhard Lorentz
President
Stiftung Mercator

Hannover/Essen, 2 November 2010

The congress programme is accompanied by several special events that provide an opportunity to exchange ideas and experiences.

Hannover

Tuesday, 2 November 2010

From 4:00 p.m. Registration

5:00 - 7:00 p.m. Opening Ceremony Hannover
Exhibition Grounds Hannover, Convention Center, Saal 1

Announcer: **Astrid Frohloff**, Rundfunk Berlin-Brandenburg, Germany

Words of Welcome

Wolfram v. Fritsch, Chairman of the Board, Deutsche Messe, Hannover, Germany

Opening Addresses

David McAllister, Premier of Lower Saxony, Hannover, Germany

Music: **Aaron Copland** - Fanfare for the Common Man

Baroness Susan Greenfield, Department of Pharmacology, University of Oxford, Great Britain

Michael Otto, Chairman of the Supervisory Board, Otto Group, Hamburg, Germany

Music: **Tylmann Susato** - Dances from "Danserye"

Young Researchers' Perspectives

Kola Liadi Mudashiru, Newcastle University, UK (OCF Fellow)

Patience Mutopo, University of Cologne, Germany (OCF Fellow)

Alexander-Kenneth Nagel, Ruhr-Universität Bochum, Germany (GYF Fellow)

Closing Remarks

Wilhelm Krull, Secretary General, Volkswagen Foundation, Hannover, Germany

7:00 p.m. Reception

Exhibition Grounds Hannover, Convention Center, Saal 3

Following the opening ceremony, Deutsche Messe invites the speakers and participants to a reception at the Convention Center.



Wednesday, 3 November 2010

Programme Schedule

Parallel Sessions 1, 2, 3

Exhibition Grounds Hannover, Convention Centre

9:00 a.m. - 12:30 p.m. Keynote Lectures

12:30 p.m. - 1:30 p.m. Lunch Break

1:30 p.m. - 5:00 p.m. Workshops

5:15 p.m. - 6:00 p.m. Closing Plenaries

6:30 - 7:00 p.m. Transfer

from exhibition grounds to Royal Herrenhausen Gardens on board the famous Silver Tram

7:15 - 10:30 p.m. Reception by the City of Hannover

The Royal Herrenhausen Gardens

The city of Hannover would like to invite all participants of the conference to an inspiring evening of enlightenment and conversation - and we are very proud to introduce you to a special location for the occasion. The Royal Herrenhausen Gardens comprise a unique ensemble of parks and gardens which are regarded as being among the most beautiful parks in Europe.

Welcome drink

accompanied by a "Herrenhausen Enlightenment Laboratory" performance

Words of Welcome

by **Stephan Weil**, Lord Mayor of Hannover, and **Wilhelm Krull**, Secretary General, Volkswagen Foundation

Keynote speech

Homi K. Bhabha, Director of the Humanities Center at Harvard University, Cambridge, USA

Casual lounge dinner

accompanied by jazz music, in the open relaxing area "Herrenhausen Biosphere" at the Orangery

From 10:30 p.m. Transfer back to hotels

Thursday, 4 November 2010

Programme Schedule

Parallel Sessions 4, 5, 6

Exhibition Grounds Hannover, Convention Centre

8:30 a.m. - 12:00 p.m. Keynote Lectures

12:00 p.m. - 1:00 p.m. Lunch Break

1:00 p.m. - 4:30 p.m. Workshops

4:45 p.m. - 5:30 p.m. Closing Plenaries

Bus Transfer to Essen

Buses will be waiting at the South Entrance to the Convention Center.

5:45 p.m. Departure from Hannover

9:00 p.m. Arrival in Essen

Further information about the musicians:

The Trombone Class Hannover - consists of former and present students of Professor Jonas Bylund. The members have been prize winners at international competitions such as the ARD Wettbewerb, Prague Spring Competition, Christian Lindberg International Trombone Competition (Valencia), and the Gdansk International Brass Competition.

Essen

Friday, 5 November 2010

From 8:00 a.m. Registration

9:00 - 10:00 a.m. Opening Ceremony Essen
Philharmonic Concert Hall Essen,
RWE-Pavillon

Opening

Bernhard Lorentz, President, Stiftung Mercator,
Essen, Germany

Fritz Pleitgen, Chairman of the Management
Board, RUHR.2010, Essen, Germany

Keynote Speech

Norbert Lammert, President of the German
Bundestag, Berlin, Germany

Programme Schedule

Parallel Sessions 7, 8, 9
Philharmonic Concert Hall Essen

10:15 a.m. - 1:15 p.m. Keynote Lectures

1:15 p.m. - 2:30 p.m. Lunch Break

2:30 p.m. - 5:45 p.m. Workshops

6:00 p.m. - 7:00 p.m. Closing Plenaries

7:15 - 10:30 p.m. Reception by RUHR.2010
Philharmonic Concert Hall Essen,
Alfried Krupp Saal

The conference Our Common Future is the highlight of the RUHR.2010 European Capital of Culture academic programme. To mark this occasion, RUHR.2010 invites all speakers, participants and additional guests to a festive dinner at the Essen Philharmonic Concert Hall.

From 6:00 p.m. Welcome Drink

7:15 p.m. Words of Welcome

Fritz Pleitgen, Chairman RUHR.2010,
Essen, Germany

Mayor Franz-Josef Britz, City of Essen, Germany

Dinner (first course)

Artistic Programme - Part One

URBANATIX - Street Art meets World Artistic:
Selected parts of the show programme featuring
tricking (a blend of martial arts and gymnastics)
and break dance

Dinner (second course)

Dinner speech: "The Ruhr Lab"

Rüdiger Frohn, Chairman of the Advisory Board,
Stiftung Mercator, Essen, Germany

Artistic Programme - Part Two

URBANATIX - Street Art meets World Artistic

Dinner (third course)

Background Jazz Music

Saturday, 6 November 2010

Programme Schedule

Parallel Sessions 10, 11, 12
Philharmonic Concert Hall Essen

9:00 a.m. - 12:30 p.m. Keynote Lectures

12:30 p.m. - 2:00 p.m. Lunch Break

2:00 p.m. - 5:15 p.m. Workshops

5:30 p.m. - 6:30 p.m. Closing Plenaries

7:00 - 8:00 p.m. Conference Closing

Philharmonic Concert Hall Essen

Panel Discussion

Anjana Devi, Ruhr-Universität Bochum, Germany
(GYF Fellow)

Wilhelm Krull, Secretary General, Volkswagen
Foundation, Hannover, Germany

Bernhard Lorentz, President, Stiftung Mercator,
Essen, Germany

Claire Major, York University, Toronto, Canada
(OCF Fellow)

Anke Nellesen, Fraunhofer Institute UMSICHT,
Oberhausen, Germany (GYF Fellow)

Closing Remarks

Bernhard Lorentz, President, Stiftung Mercator,
Essen, Germany

8:00 p.m. Bus Transfer to Zeche Zollverein

From 8:30 p.m. Party at Zeche Zollverein

Further information about the artists:

URBANATIX:

URBANATIX is an innovative presentation of modern physical art as part of RUHR.2010, empowering young street art talents from 21 cities throughout North Rhine-Westphalia. The show programme features ten young artists and one top act. For further information about the project see: www.urbanatix.de

Jazz Ensemble:

Six young musicians and a selection of famous jazz and pop classics in a set that ranges from soft, melancholy tunes to upbeat and exciting pieces. The artists got to know each other through their membership of the Youth Jazz Orchestra of North Rhine-Westphalia.



Global Health and Molecular Medicine I

Scientific Advisor: Axel Haverich

Session 1
Hannover, 3 November 2010

9:00 a.m. Opening | Saal 1A

Axel Haverich, Hannover Medical School, Germany

9:15 a.m. Keynote Lectures | Saal 1A

Chair: Axel Haverich

Cancer and Infectious Diseases in Africa - a Medical and Demographical Reality

Kwabena Frimpong-Boateng, Korle Bu Teaching Hospital, Accra, Ghana

Infectious Diseases - Effects of Innovative Counter Attacks on Global Health

Rudi Balling, University of Luxembourg, Luxembourg

11:00 a.m. Coffee Break

11:30 a.m. Cancer - a Global Vision for Prevention and Cure

Otmar D. Wiestler, German Cancer Research Center, Heidelberg, Germany

12:30 p.m. Lunch Break

1:30 p.m. Workshop 1.1 | Saal 15/16

Infectious Diseases - Molecular Research - Global Effects

Chair: Rudi Balling

Speakers:

Dionicia Gamboa, Instituto de Medicina Tropical Alexander von Humboldt, Lima, Peru (OCF Fellow)

Astrid Westendorf, University of Duisburg-Essen, Germany (GYF Fellow)

Julia Bandow, Ruhr-Universität Bochum, Germany (GYF Fellow)

Workshop 1.2 | Saal 12

Cancer - From Molecular Research to Improved Global Health

Chair: Michael Manns, Hannover Medical School, Germany

Speakers:

Andreas Trumpp, German Cancer Research Center, Heidelberg, Germany

Tim Ripperger, Hannover Medical School, Germany (OCF Fellow)

Stefan Kasper, University of Duisburg-Essen, Germany (GYF Fellow)

3:00 p.m. Coffee Break

3:30 p.m. Speakers:

Petra Gastmeier, Charité, Berlin, Germany

Alexander Mark Supady, Harvard University, Cambridge, USA (OCF Fellow)

Constance Georgina Walyaro, Citron Wood Foundation, Nairobi, Kenya (OCF Fellow)

Speakers:

Hans Hofstraat, Philips Research Laboratories, Eindhoven, Netherlands

Kai Stühler, Ruhr-Universität Bochum, Germany (GYF Fellow)

Perihan Nalbant, Ruhr-Universität Bochum, Germany (GYF Fellow)

5:00 p.m. Break

5:15 p.m. Closing Plenary | Saal 1A

-6:00 p.m.

Chairs: Axel Haverich/Karl Lenhard Rudolph, Ulm University, Germany

Our Chromosome Ends: How Do They Affect Health and Disease and Can we Change Them?

Elizabeth Blackburn, University of California, San Francisco, USA



Future Technologies I: Communication

Scientific Advisor: Wolfgang Wahlster

Session 2
Hannover, 3 November 2010

9:00 a.m. Opening | Saal 1B

Wolfgang Wahlster, German Research Center for Artificial Intelligence, Saarbrücken, Germany

9:15 a.m. Keynote Lectures | Saal 1B

Chair: Peter Post, Festo AG, Esslingen, Germany

Towards a Future Internet Architecture

Anja Feldmann, Deutsche Telekom Laboratories/Technische Universität Berlin, Germany

The Future of Communication between Virtual and Real Bodies

Justine Cassell, Carnegie Mellon University, Pittsburgh, USA

11:00 a.m. Coffee Break

11:30 a.m. Ambient Intelligence and Smart Environments

Hideyuki Nakashima, Future University Hakodate, Japan

12:30 p.m. Lunch Break

1:30 p.m. Workshop 2.1 | Saal 13/14

Internet of Services for Developing Countries

Chair: Joachim Schaper, SAP AG, Walldorf, Germany

Speakers:

Lutz Heuser, AGT International, Glattbrugg, Switzerland

'Gbenga Sesan, Paradigm Initiative Nigeria, Lagos, Nigeria (OCF Fellow)

Merlyna Lim, Arizona State University, Tempe, USA (OCF Fellow)

3:00 p.m. Coffee Break

3:30 p.m. Workshop 2.2 | Saal 13/14

Ambient Assisted Living

Chair: Wolfgang Wahlster

Speakers:

Didier Stricker, German Research Center for Artificial Intelligence, Kaiserslautern, Germany

Sandra Sülzenbrück, Leibniz Research Centre for Working Environment and Human Factors, Dortmund, Germany (GYF Fellow)

5:00 p.m. Break

5:15 p.m. Closing Plenary | Saal 1B

-6:00 p.m. Chair: Anja Feldmann

The Future of Communication

Wolfgang Wahlster



Economic Development for Global Inclusion

Scientific Advisor: Stephan Klasen

Session 3
Hannover, 3 November 2010

9:00 a.m. Opening | Saal 3

Stephan Klasen, University of Göttingen, Germany

9:15 a.m. Keynote Lectures | Saal 3

Chair: Stephan Klasen

Opportunities and Challenges for Inclusion of the 'Bottom Billion'

Paul Collier, University of Oxford, UK

Commentary: Francisco Ferreira, World Bank, Washington DC, USA

Opportunities for African Development after the Economic and Financial Crisis: What Must Africa and the International Community Do?

Emmanuel Tumusiime-Mutebile, Bank of Uganda, Kampala, Uganda

Commentary: Katharina Michaelowa, University of Zurich, Switzerland

11:00 a.m. Coffee Break

11:30 a.m. How Can Emerging Economies Help Promote Global Development: the Role of Trade, Investment, Aid, Technology and Policy

François Bourguignon, Paris School of Economics, France

Commentary: Joachim von Braun, Center for Development Research, Bonn, Germany

12:30 p.m. Lunch Break

1:30 p.m. Workshop 3.1 | Saal 17

Policy Coherence in Development Policy

Chair: Paul Collier

Speakers:

Katharina Michaelowa

Amrei Horstbrink, United Nations Institute for Training, Geneva, Switzerland (OCF Fellow)

3:00 p.m. Coffee Break

3:30 p.m. Speakers:

Francisco Ferreira

Tracy Jooste, Palmer Development Group, Cape Town, South Africa (OCF Fellow)

1:30 p.m. Workshop 3.2 | Saal 15/16

Food, Energy and Finance: Lessons from the Crisis and Opportunities for Future Development

Chair: Joachim von Braun

Speakers:

Máximo Torero, International Food Policy Research Institute, Washington DC, USA

Nnaemeka Ikegwuonu, The Smallholders Foundation, Owerri, Imo State, Nigeria

Speakers:

Joy M. Kiiru, University of Nairobi, Kenya (OCF Fellow)

Stéphanie Giamporcaro, University of Cape Town, South Africa (OCF Fellow)

5:00 p.m. Break

5:15 p.m. Closing Plenary | Saal 3

-6:00 p.m. Chair: Stephan Klasen

Windows to Future Development

Sir Partha Dasgupta, University of Cambridge, UK

Commentary: Máximo Torero



Climate Change and Energy I

Scientific Advisor: Hans Joachim Schellnhuber

8:30 a.m. **Opening | Saal 1A**

Hans Joachim Schellnhuber, Potsdam Institute for Climate Impact Research, Germany

8:45 a.m. **Keynote Lectures | Saal 1A**

Chair: Wilhelm Krull, Secretary General, Volkswagen Foundation, Hannover, Germany

How Dangerous is Climate Change?

Hans Joachim Schellnhuber

Mitigation and Adaptation

Ottmar Edenhofer, Potsdam Institute for Climate Impact Research, Germany

Commentary: Stefan Rahmstorf, Potsdam Institute for Climate Impact Research, Germany

10:30 a.m. **Coffee Break**

11:00 a.m. **The Energy Revolution**

Nebojsa Nakicenovic, International Institute for Applied Systems and Analysis and Vienna University of Technology, Austria

Commentary: Werner Schnappauf, BDI - Federation of German Industries, Berlin, Germany

12:00 p.m. **Lunch Break**

1:00 p.m. **Workshop 4.1 | Saal 15/16**

Technologies to Save the World

Chair: Hermann Requardt, Siemens AG, Munich, Germany

Speakers:

Ottmar Edenhofer

Cornel Zwierlein, Ruhr-Universität Bochum, Germany (GYF Fellow)

Robert Güttel, Clausthal University of Technology, Germany (GYF Fellow)

2:30 p.m. **Coffee Break**

3:00 p.m. **Speakers:**

Christoph Bals, Germanwatch, Bonn, Germany

Liadi Mudashiru, Newcastle University, UK (OCF Fellow)

1:00 p.m. **Workshop 4.2 | Saal 12**

Climate Justice, Climate Governance

Chair: Klaus Töpfer, Institute for Advanced Sustainability Studies, Potsdam, Germany

Speakers:

Frank Biermann, VU University Amsterdam, Netherlands

James Evans, University of Manchester, UK (OCF Fellow)

Clare Saunders, University of Southampton, UK (OCF Fellow)

4:30 p.m. **Break**

4:45 p.m. **Closing Plenary | Saal 1A**

- 5:30 p.m. **Chair:** Klaus Töpfer

A Vision for Sustainable Innovation

Carlo Rubbia, CERN, Geneva, Switzerland and Institute for Advanced Sustainability Studies, Potsdam, Germany



Future Technologies II: Mobility

Scientific Advisor: Andreas Knie

Session 5
Hannover, 4 November 2010

8:30 a.m. Opening | Saal 1B

Andreas Knie, Social Science Research Center Berlin, Germany

8:45 a.m. Keynote Lectures | Saal 1B

Chair: Andreas Knie

Perspectives for a Sustainable Mobility

Gerd-Axel Ahrens, Technische Universität Dresden, Germany

E-Mobility and the Future of Renewable Energies

Rolf Kreibich, Institute for Future Studies and Technology Assessment, Berlin, Germany

10:30 a.m. Coffee Break

11:00 a.m. Steps into Postfossil Mobility

Dan Sperling, University of California, Davis, USA

12:00 p.m. Lunch Break

1:00 p.m. Workshop 5.1 | Saal 13/14

Technologies for Postfossil Mobility

Chair: Michael Mönninger, Braunschweig University of Art, Germany

Speakers:

Sandra Krommes, BMW AG, Munich, Germany

Klaus Harms, Robert Bosch GmbH, Stuttgart, Germany

Bob Jeffery, University of Salford, UK (OCF Fellow)

2:30 p.m. Coffee Break

3:00 p.m. Workshop 5.2 | Saal 13/14

Opportunities and Limits of Intermodal Concepts

Chair: Michael Gleich, publicist, Berlin, Germany

Speakers:

Andreas Knie

Charisma Choudhury, Bangladesh University of Engineering and Technology, Dhaka, Bangladesh (OCF Fellow)

Johann Tomforde, hymer idc GmbH, Pforzheim, Germany

4:30 p.m. Break

4:45 p.m. Closing Plenary | 1B

- 5:30 p.m. Chair: Andreas Knie

Mobility in Times of Climate Change: Technology Fix versus Behaviour Change

Glenn Lyons, University of the West of England, Bristol, UK



Human Rights - Global Culture - International Institutions

Scientific Advisors: Dieter Grimm, Jutta Limbach

Session 6
Hannover, 4 November 2010

8:30 a.m. Opening | Saal 3

Jutta Limbach, former President of the German Federal Constitutional Court, Karlsruhe, Germany
Dieter Grimm, Institute for Advanced Study, Berlin, Germany

8:45 a.m. Keynote Lectures | Saal 3

Chair: Dieter Grimm

Exchanging Justice for Truth is an Embrace of Evil: a View on Human Rights through the South African Truth and Reconciliation Commission

Antjie Krog, University of the Western Cape, Cape Town, South Africa

Human Rights, Sovereignty and Democratic Iterations

Seyla Benhabib, Yale University, New Haven, USA

10:30 a.m. Coffee Break

11:00 a.m. Protection of Human Rights in the European Union

Andreas Voßkuhle, German Federal Constitutional Court, Karlsruhe, Germany

12:00 p.m. Lunch Break

1:00 p.m. Workshop 6.1 | Saal 17

The Future of International Law

Chair: Jochen Frowein, Max Planck Institute for Comparative Public Law and International Law, Heidelberg, Germany

Speakers:

Andreas Paulus, German Federal Constitutional Court, Karlsruhe, Germany
Liav Orgad, Interdisciplinary Center Herzliya, Israel (OCF Fellow)
Andrea Kirsch, Ruhr-Universität Bochum, Germany (GYF Fellow)

Workshop 6.2 | Saal 18

Towards a Global Community of Human Rights Law

Chair: Jutta Limbach

Speakers:

Antonio Cassese, Special Tribunal for Lebanon, Leidschendam, Netherlands
Valeska Huber, University of Konstanz, Germany (OCF Fellow)
Patience Mutopo, University of Cologne, Germany (OCF Fellow)

2:30 p.m. Coffee Break

3:00 p.m.

Speakers:

Anne Peters, University of Basel, Switzerland
Alida Anél du Plessis/Louis Kotzé, North West University, Potchefstroom, South Africa (OCF Fellows)

Speakers:

Claus Offe, Hertie School of Governance, Berlin, Germany
Rhuks Temitope Ako, University of Hull, UK (OCF Fellow)
Nina Lück, University of Oldenburg, Germany (OCF Fellow)

4:30 p.m. Break

4:45 p.m. Closing Plenary | Saal 3

- 5:30 p.m. Chairs: Jutta Limbach/Dieter Grimm

Human Rights and Cultural Narratives

Homi Bhabha, Harvard University, Cambridge, USA

Climate Change and Energy II

Scientific Advisor: Reinhard Hüttl

Session 7
Essen, 5 November 2010

10:15 a.m. Opening | Festsaal

Reinhard Hüttl, GFZ German Research Centre for Geosciences, Potsdam, Germany

10:30 a.m. Keynote Lectures | Festsaal

Chair: Reinhard Hüttl

Understanding System Earth

Reinhard Hüttl

11:15 a.m. Coffee Break

11:45 a.m. Water and Sustainability in a Global Perspective

Wolfgang Kinzelbach, Swiss Federal Institute of Technology (ETH) Zurich, Switzerland

Soils and Land Use

Rattan Lal, Ohio State University, Columbus, USA

Bioeconomy: The Efficient Use of Biomass

Joachim von Braun, Center for Development Research, Bonn, Germany



1:15 p.m. Lunch Break

2:15 p.m. Workshop 7.1 | Festsaal

Adaptation Strategies I: Sustainable Use of Natural Resources

Chair: Joachim von Braun

Speakers:

Hannes Flühler, Swiss Federal Institute of Technology (ETH) Zurich, Switzerland
Luca Marmo, European Commission, Brussels, Belgium
Harry Vereecken, Research Centre Jülich, Germany
Ramachandran Nair, University of Florida, Gainesville, USA
Saloua Rochdane, Cadi Ayyad University, Marrakesh, Morocco (OCF Fellow)

Workshop 7.2 | Grüner Saal

Adaptation Strategies II: Impact on Man

Chair: Reinhard Hüttl

Speakers:

Günther Wess, German Research Center for Environmental Health, Munich, Germany
Bernd Hillemeier, Technische Universität Berlin, Germany
Bernhard Müller, Technische Universität Dresden, Germany
Antonio Tironi, University of Chile, Santiago de Chile, Chile (OCF Fellow)

3:45 p.m. Coffee Break

4:15 p.m. Speakers:

Stephen Nortcliff, University of Reading, UK
Volker Mosbrugger, Senckenberg Research Institute and Natural History Museum, Frankfurt, Germany
Ulrich Schurr, Research Centre Jülich, Germany
Roberto Rinaldi, Max Planck Institut für Kohlenforschung (coal research), Mülheim an der Ruhr, Germany (GYF Fellow)

Speakers:

Jochen Zschau, GFZ German Research Centre for Geosciences, Potsdam, Germany
Bruno Merz, GFZ German Research Centre for Geosciences, Potsdam, Germany
Nomé Sakané, National Museums of Kenya, Nairobi, Kenya (OCF Fellow)
Franz Mauelshagen, Institute for Advanced Study in the Humanities (KWI), Essen, Germany (GYF Fellow)

5:45 p.m. Break

6:00 p.m. Closing Plenary | Festsaal

-7:00 p.m. Chair: Reinhard Hüttl

Facing Climate Change - the Google Earth Project

Florian Leese, Ruhr-Universität Bochum, Germany (GYF Fellow)

Managing System Earth-Man: Why We Need Adaptation

Reinhard Hüttl



Future Technologies III: The Factory of the Future

Scientific Advisor: Fritz Klocke

Session 8
Essen, 5 November 2010

10:15 a.m. Opening | Weißer Saal

Fritz Klocke, RWTH Aachen University and Fraunhofer Institute for Production Technology (IPT), Aachen, Germany

10:30 a.m. Keynote Lectures | Weißer Saal

Chair: Fritz Klocke

What Are the Global Driving Forces and How Do They Influence Production?

Fred van Houten, Technical University of Twente, Netherlands

11:15 a.m. Coffee Break

11:45 a.m. Chair: Fred van Houten

Organization in Production: What are New Business Structures in Manufacturing?

Andreas Ritzenhoff, Seidel GmbH, Marburg, Germany

Shaping the Future by Adding Value: Which New Manufacturing Technologies Can Face the Future?

Fritz Klocke

Resource Efficiency, Sustainability and Global Supply Chains: Global Market and Supply Chain Challenges

David Simchi-Levi, Massachusetts Institute of Technology, Cambridge, USA

1:15 p.m. Lunch Break

2:15 p.m. Workshop 8.1 | Weißer Saal

Organization in Production

Chair: Andreas Ritzenhoff

Speakers:

Thomas Bauernhansl, Freudenberg GmbH, Heidelberg, Germany

Stephan Kessler, TU Dortmund University, Germany (GYF Fellow)

3:45 p.m. Coffee Break

4:15 p.m. Workshop 8.2 | Weißer Saal

New Manufacturing Technologies

Chair: Fritz Klocke

Speakers:

Luc de Ferran, Industrial Consultant and former Vice President Ford Latin America Group, São Paulo, Brazil

Ayşe İdil Gaziulusoy, University of Auckland, New Zealand (OCF Fellow)

5:45 p.m. Break

6:00 p.m. Workshop 8.3 | Weißer Saal

- 7:00 p.m.

Global Market and Supply Chain Challenges

Chair: David Simchi-Levi

Speakers:

Stefan Hartung, Robert Bosch GmbH, Stuttgart, Germany

Tan Kim Hua, University of Nottingham, UK (OCF Fellow)



Migration and Integration: Global Tensions - Local Responses

Scientific Advisors: Klaus J. Bade, Ludger Pries

Session 9
Essen, 5 November 2010

10:15 a.m. Opening | RWE-Pavillon

Klaus J. Bade, Expert Council of German Foundations on Integration and Migration, Berlin, Germany

10:30 a.m. Keynote Lecture | RWE-Pavillon

Chair: Klaus J. Bade

Migration and Transnationalism in a Global Perspective

Steven Vertovec, Max Planck Institute for the Study of Religious and Ethnic Diversity, Göttingen, Germany

11:15 a.m. Coffee Break

11:45 a.m. Workshop 9.1 | RWE-Pavillon

Rural-Urban Migrations in Mega Cities and 'Mega-Slums'

Chair: Ludger Pries, Ruhr-Universität Bochum, Germany

Speakers:

Li Wei, Chinese Academy of Social Sciences, Beijing, China

Peter Taylor, Loughborough University, UK

Bettina Gransow, Freie Universität Berlin, Germany

1:15 p.m. Lunch Break

2:15 p.m. Workshop 9.2 | RWE-Pavillon

Networks, Migration and Development

Chair: Ludger Pries

Speakers:

Robert Smith, City University of New York, USA

Colin McFarlane, Durham University, UK

Xóchitl Castañeda, University of California, Berkeley, USA/

Marc B. Schenker, University of California, Davis, USA

3:45 p.m. Coffee Break

4:15 p.m. Workshop 9.3 | RWE-Pavillon

Migration of Highly Qualified Persons and the Globalization of Education Systems

Chair: Klaus J. Bade

Speakers:

Knuth Dohse, Social Science Research Center Berlin, Germany

Wei Shen, École Supérieure des Sciences Commerciales d'Angers (ESSCA), Paris, France (OCF Fellow)

Arthur Sweetman, McMaster University, Hamilton, Canada

5:45 p.m. Break

6:00 p.m. Closing Plenary | RWE-Pavillon

- 7:00 p.m.

Panel Discussion: Global Migration and World Economy: Experiences and Challenges

Chair: Ludger Pries

Panel Discussants:

Eva Dick, TU Dortmund University, Germany (GYF Fellow)

Herbert Kircher, former CEO of IBM Germany, Böblingen, Germany

Barbara Laubenthal, Ruhr-Universität Bochum, Germany (GYF Fellow)

Luo Rumin, Bielefeld University, Germany (OCF Fellow)



Global Health and Molecular Medicine II

Scientific Advisor: Karl Lenhard Rudolph

Session 10
Essen, 6 November 2010

9:00 a.m. Opening | Weißer Saal

Karl Lenhard Rudolph, Ulm University, Germany

9:15 a.m. Keynote Lectures | Weißer Saal

Chair: Karl Lenhard Rudolph

Can Human Life Expectancy Rise Dramatically?

Aubrey de Grey, SENS Foundation, Cambridge, UK

Development in Human Health and Life Expectancy in Developed and Non-Developed Countries

Colin D. Mathers, World Health Organization, Geneva, Switzerland

How Do Changes in Human Longevity Impact on our Demography?

Leonid Gavrilov and Natalia Gavrilova, University of Chicago, USA

11:00 a.m. Coffee Break

11:30 a.m. Chair: Hans R. Schöler, Max Planck Institute for Molecular Biomedicine, Münster, Germany

Stem Cells in Aging and Cancer - New Targets for Interventions?

Irving Weissman, Stanford University, Palo Alto, USA

Equitable Global Health

Stefan Raunser, Max Planck Institute of Molecular Physiology, Dortmund, Germany (GYF Fellow)

Adina Rusu, Ruhr-Universität Bochum, Germany (GYF Fellow)

12:30 p.m. Lunch Break

1:45 p.m. Workshop 10.1 | Weißer Saal

Molecular Mechanisms of Aging

Chair: Björn Schumacher, University of Cologne, Germany

Co-Chair: Luis Miguel Guachalla, Ulm University, Germany (OCF Fellow)

Speakers:

Jan Hoeijmakers, Erasmus University Rotterdam, Netherlands

Tom Kirkwood, Newcastle University, UK

3:15 p.m. Coffee Break

3:45 p.m. Workshop 10.2 | Weißer Saal

Emerging Therapies

Chair: Irving Weissman

Co-Chair: Hannes Klump, University of Duisburg-Essen, Germany (GYF Fellow)

Speakers:

Karl Lenhard Rudolph

Hans R. Schöler

5:15 p.m. Break

5:30 p.m. Closing Plenary | Weißer Saal

-6:30 p.m. Panel Discussion: Increase in Life Expectancy, Health Span: Effects on Health Care Costs and Effects of Social Status

Chair: Colin D. Mathers

Introduction:

Liming Cai, Office of the Actuary, Centers for Medicare and Medicaid Services, Baltimore, USA

Further Panel Discussants:

Anja Hartmann, Ruhr-Universität Bochum, Germany (GYF Fellow)

Jan Hoeijmakers

Irving Weissman

Metropolis

Scientific Advisor: Volker Kreibich

9:00 a.m. Opening | RWE-Pavillon

Volker Kreibich, TU Dortmund University, Germany

9:15 a.m. Keynote Lectures | RWE-Pavillon

The 21st Century Metropolis

Ananya Roy, University of California, Berkeley, USA

Maximum Cities: Mumbai, New York

Suketu Mehta, New York University, New York, USA

11:00 a.m. Coffee Break

11:30 a.m. The European City in the 20th Century

Vittorio M. Lampagnani, Swiss Federal Institute of Technology (ETH) Zurich, Switzerland

European Industrial Agglomerations: Metropolitan Urban Landscapes?

Christoph Zöpel, Berlin, Germany

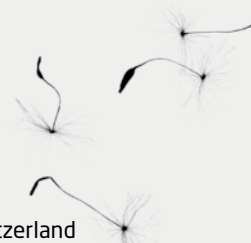

12:30 p.m. Lunch Break

1:45 p.m. Workshop 11.1 | RWE-Pavillon

Urbanisation in Poverty: From Exclusion to Inclusion?

Chair: Suketu Mehta

Speakers:

Wilbard J. Kombe, Ardhi University, Dar es Salaam, Tanzania

Reena Singh, New Delhi, India (OCF Fellow)

Christoph Woiwode, TU Dortmund University (GYF Fellow)

1:45 p.m. Workshop 11.2 | Grüner Saal

Industrial Legacy: Asset or Burden in Global Competition?

Chair: Sabine Baumgart, TU Dortmund University, Germany

Speakers:

Einhard Schmidt-Kallert, TU Dortmund University, Germany

Sabine Weck, Research Institute for Regional and Urban Development (ILS), Dortmund, Germany (GYF Fellow)

Sébastien Breau, McGill University, Montreal, Canada (OCF Fellow)

3:15 p.m. Coffee Break

3:45 p.m. Workshop 11.3 | RWE-Pavillon

The Right to the City - Participative Urban Governance

Chair: Ananya Roy

Speakers:

Carole Rakodi, University of Birmingham, UK

Deljana Iossifova, University of Westminster, London, UK (OCF Fellow)

Julien Rebotier, Centre National de la Recherche Scientifique, Pau, France

3:45 p.m. Workshop 11.4 | Grüner Saal

Managing Structural Change in Partnered Governance

Chair: Rainer Danielzyk, Research Institute for Regional and Urban Development (ILS), Dortmund, and Leibniz Universität Hannover, Germany

Speakers:

Jean Hillier, Newcastle University, UK

Gerald Wood, University of Münster, Germany

Zhu Qian, University of Waterloo, Canada (OCF Fellow)

5:15 p.m. Break

5:30 p.m. Closing Plenary | RWE-Pavillon

- 6:30 p.m. The Interchange of Economy and Urban Diversity - A Case Study of Metropolis Istanbul

Chair: Volker Kreibich

Speakers:

Steffen Brinckmann, Ruhr-Universität Bochum, Germany (GYF Fellow)

Jörg Plöger, Research Institute for Regional and Urban Development (ILS), Dortmund, Germany (GYF Fellow)

Darja Reuschke, University of Trier, Germany (GYF Fellow)

Monika Salzbrunn, Université de Lausanne, Switzerland (GYF Fellow)

Korinna Schönhärl, University of Duisburg-Essen, Germany (GYF Fellow)

Religion and Values

Scientific Advisor: Hans Joas

9:00 a.m. **Opening | Festsaal**

Hans Joas, Max-Weber-Kolleg, University of Erfurt, Germany

9:15 a.m. **Keynote Lectures | Festsaal**

The Globalization of Christianity

Philip Jenkins, Pennsylvania State University, University Park, USA

Demography and Religion

Pippa Norris, Harvard University, Cambridge, USA

11:00 a.m. **Coffee Break**

11:30 a.m. **Huntington Reconsidered. The Dynamics of Religious and Political Conflicts**

Dieter Senghaas, University of Bremen, Germany

12:30 p.m. **Lunch Break**

1:45 p.m. **Workshop 12.1 | Festsaal**

The Globalization of Christianity

Chairs: Hans Joas/Philip Jenkins

Speakers:

Joseph Cardinal Zen, SDB, Hong Kong, China

Alexander-Kenneth Nagel, Ruhr-Universität Bochum, Germany (GYF Fellow)

3:15 p.m. **Coffee Break**

3:45 p.m. **Workshop 12.2 | Festsaal**

Demography and Religion

Chairs: Hans Joas/Pippa Norris

Speakers:

Daniel Silver, University of Toronto, Canada

Julia Lerner, Ben Gurion University, Beer Sheva, Israel (OCF Fellow)

5:15 p.m. **Break**

5:30 p.m. **Workshop 12.3 | Festsaal**

- 6:30 p.m.

The Dynamics of Religious and Political Conflicts

Chairs: Hans Joas/Dieter Senghaas

Speakers:

Ashis Nandy, Centre for the Study of Developing Societies, New Delhi, India

Abida Malik, University of Nottingham, UK (OCF Fellow)



Climate Change and Energy

During the last decade, climate change has become one of the most heatedly and publicly debated issues worldwide. The phenomenon itself is anything but new. Today, however, the term no longer refers to climate changes caused by natural phenomena, but to those brought about by human technology and human behaviour. Man has become both the causer and the victim of global climate change.

Undoubtedly, there is an urgent need to find new approaches and solutions in order to deal with climate change. New technologies for energy efficiency and renewable energy sources can play a key role in this context. Questions needing to be asked and answered include the following: How can technology-based inventions contribute to reducing greenhouse gases? How can the enormous energy-saving potentials in buildings and transport be exploited efficiently? Is it enough to face climate change with technological innovations, or does this challenge to the future of mankind call for even more fundamental changes?



Reinhard Hüttl

1978 to 1983 degree in forest and soil sciences at the University of Freiburg and Oregon State University; 1986 doctorate at the University of Freiburg; since 2007 Scientific Director of the German Research Centre for Geosciences (GFZ) in Potsdam; since 2008 President of acatech (German Academy of Science and Engineering).



Hans Joachim Schellnhuber

1980 doctorate in theoretical physics, University of Regensburg; 1985 habilitation and 1988 Professor of Theoretical Physics, University of Oldenburg; 1991 Founding Director of the Potsdam Institute for Climate Impact Research (PIK); since 1993 Director of PIK and Professor of Theoretical Physics at Potsdam University; Chair of the German Advisory Council on Global Change (WBGU); member of the High-Level Expert Group on Energy & Climate Change advising the President of the European Commission; member of the Intergovernmental Panel on Climate Change (IPCC).

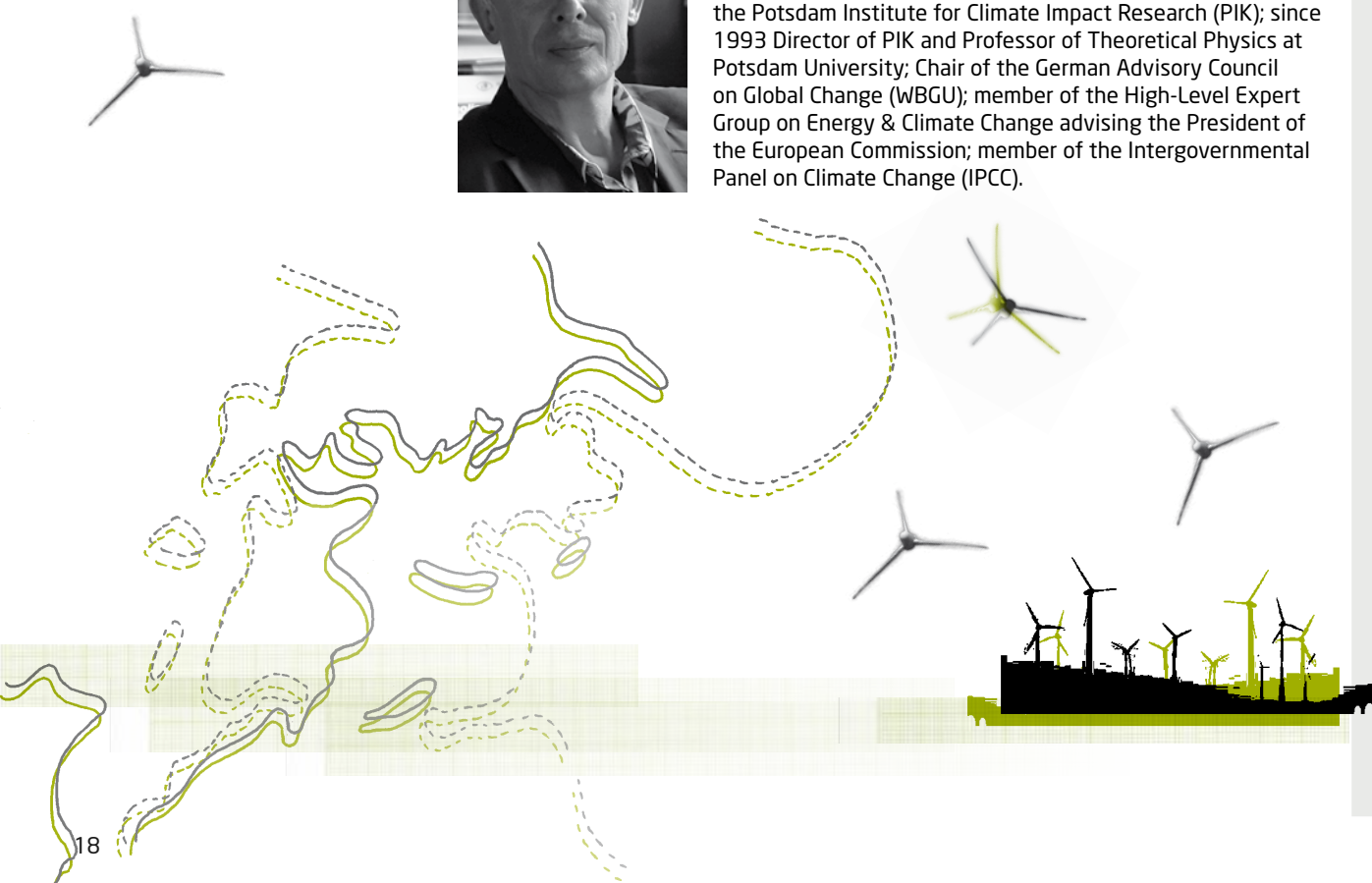

Future Technologies

Technological progress has shaped and changed the ways we travel, work and communicate. Global digital communication facilitates new forms of interaction between man and machine. New transport technologies open new markets and turn the world into a global village. New business structures and manufacturing technologies boost production rates.

Increasing productivity and mobility, however, lead not only to new opportunities for economic growth, but also to new challenges to ensure its sustainability. Issues such as resource efficiency or post-fossil mobility need to be urgently addressed.

Questions to be asked and answered include the following: how should our future look in terms of communication, mobility and production modes? How will new communication technologies affect the man-machine relationship? How can we improve transport efficiency and implement a more sustainable transport policy? Which energy-saving production technologies are needed? How do we envisage the factory of the future?



Fritz Klocke

1982 doctorate in engineering at the Technische Universität Berlin; 1984 to 1994 Technical Director at Ernst Winter & Sohn Hamburg; since 1995 Professor of Manufacturing Technology and Co-Director of WZL Laboratory for Machine Tools and Production Engineering at RWTH Aachen University and head of the Fraunhofer Institute for Production Technology (IPT) in Aachen.



Andreas Knie

1990 doctorate in political science, Technische Universität Berlin; since 1987 Senior Fellow at the Social Science Research Centre Berlin (WZB); since 2000 Professor of Sociology at the Technische Universität Berlin; since 2006 Managing Director of the Innovation Centre for Mobility and Societal Change (InnoZ).



Wolfgang Wahlster

1981 doctorate in computer science, University of Hamburg; since 1984 Professor of Computer Science at Saarland University, Saarbrücken; since 1988 Scientific Director of the German Research Center for Artificial Intelligence (DFKI GmbH), Saarbrücken; since 1996 Director and CEO of the DFKI; 2001 laureate of the German Future Prize.

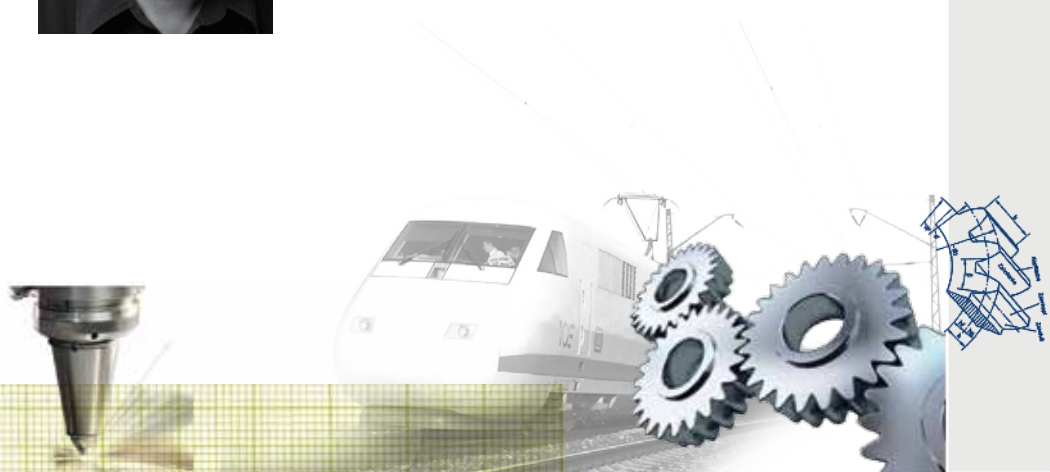

Economic and Urban Development

The current economic crisis has revealed the structural vulnerability of a globally interconnected and interdependent economic system. At the same time, it reminds us of our global responsibility and of the questions we need to address: how can we transform the economic basis of societies in industrialized and developing countries to make it sustainable? Which conditions are necessary for global trade to advance competition while at the same time inhibiting exploitation? How do we ensure policy coherence in development policy? How can we foster sustainable economic growth that effectively reduces poverty?

These questions will pose themselves most urgently in urban regions. While it is estimated that 90 percent of the global increase in population will take place in the urban areas of developing countries, the predominant trend in the industrialized world is a relocation of the city population to rural areas.



Stephan Klasen

1994 PhD in economics, Harvard University; 1998 Professor of Economics, University of Munich; since 2003 Professor of Economics and Head of the Ibero-American Institute at the University of Göttingen; consultant on research and development projects for the World Bank, OECD, UNDP, UNESCO and German development cooperation.



Volker Kreibich

Masters degree in geography at the University of Colorado, USA; doctoral degree at the Technical University of Munich; urban development planner at the Municipality of Munich; until 2005 Professor of Spatial Planning in Developing Countries at the Faculty of Spatial Planning, TU Dortmund University; present research focus on urbanization in poverty and informal modes of urban governance with a regional emphasis on East Africa and South Asia.

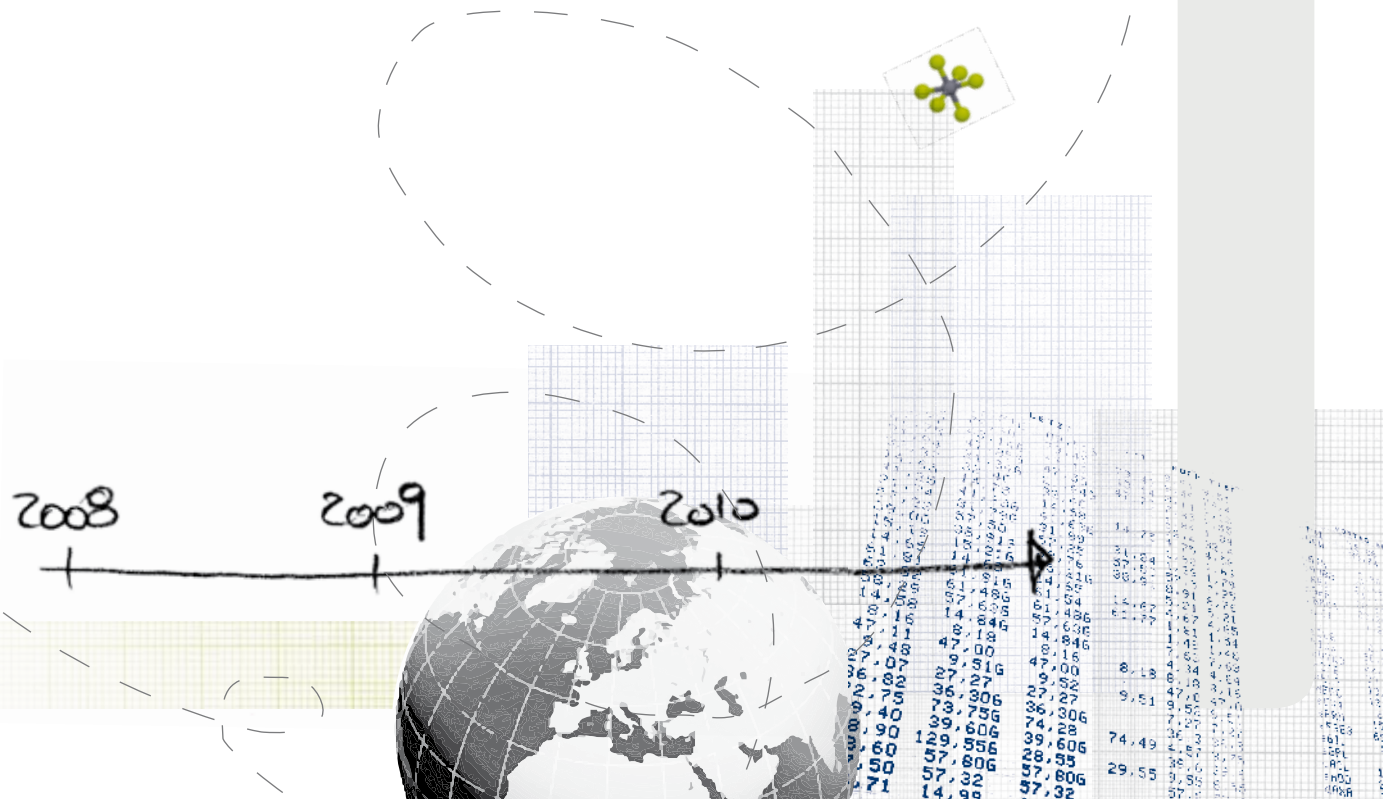

Global Health and Molecular Medicine

Reducing infant mortality, improving maternal health and combating HIV/AIDS, malaria and other diseases are three of the eight Millennium Development Goals agreed upon by the United Nations. Achieving these goals will have a crucial bearing on the development of the world's poorest countries. In industrialized countries, however, "anti-aging" and "regenerative medicine" are buzz-words in the context of accelerated progress in experimental research and its applied therapeutic practice.

This might prompt the following questions: How can universal access to drugs be guaranteed? How do we deal with epidemics or pandemics that arise as a result of global climate change? What are the implications of high-tech medicine for patients? Which answers do ethics offer modern medicine? How can the increasingly cost-intensive health system of aging western societies be financed and managed?



Axel Haverich

1979 doctorate in medicine, Hannover Medical School (MHH); 1983 to 1984 Department of Cardiovascular Surgery, Stanford University; 1993 Head of the Department for Cardiac and Vascular Surgery at the University of Kiel; 1995 Leibniz Prize laureate; since 1996 Head of the Department of Cardiothoracic, Transplant and Vascular Surgery at Hannover Medical School.



Karl Lenhard Rudolph

1989 to 1996 degree in medicine at the University of Göttingen; 1997 to 1998 internship at Hannover Medical School; 1998 post-doc at Albert Einstein College in New York and Dana Faber Cancer Institute in Boston; 2001 Emmy Noether Fellowship at Hannover Medical School; 2006 Heisenberg professorship; 2009 Leibniz Prize laureate; since 2007 Director of the Institute of Molecular Medicine and head of the Max Planck Research Group for Stem Cell Aging at the University of Ulm.



Human Rights and Global Values

Globalization is not only an economic phenomenon, but also comprises legal, social and cultural factors. Questions to be asked and answered include the following: What will global governance and “global law” look like in the future? What options do international courts have? How will they be influenced by different concepts of human and civil rights? How can we achieve effective worldwide protection of human rights?

In future, the world will increasingly be faced with migration flows as a result of globalization, climate change, pandemics and new technological achievements. In many countries, rural exodus will lead to the emergence of new mega cities. Migration between developing and industrialized countries will also increase. How can societies deal with the future global competition for highly qualified experts?

Cultural globalization also leads to new religious developments. What does “renaissance of religion” mean in this context? Under which conditions do religions defuse or intensify conflicts?



Klaus J. Bade

1972 to 1979 study of history, political science, social sciences and German literature; 1982 to 2007 Professor of Modern and Contemporary History at Osnabrück University; 1991 Founding Director of the Institute for Migration Research and Intercultural Studies (IMIS), Osnabrück University; many awards, including 2002 Philip Morris Research Prize; since 2008 Chair of the Expert Council of German Foundations on Integration and Migration in Berlin.



Dieter Grimm

1965 Master of Laws (LLM), Harvard University; 1971 doctorate in law, University of Frankfurt; 1979 Professor of Public Law, University of Bielefeld; 1987 to 1999 Justice of the Federal Constitutional Court; 2000 Professor of Public Law, Humboldt University of Berlin; 2001 to 2007 Rector of the Wissenschaftskolleg zu Berlin; Visiting Professor at Yale Law School.



Hans Joas

1968 to 1971 study of sociology, philosophy, history and German literature; 1979 doctorate; 1984 to 1987 Heisenberg fellow at the Max Planck Institute for Human Development in Berlin; 1990 to 2002 Chair at the John F. Kennedy Institute for North American Studies and the Institute for Sociology at the Freie Universität Berlin; since 2000 Professor of Sociology and member of the Committee on Social Thought at the University of Chicago; since 2002 Max Weber Professor of Sociology and Director of the Max Weber Center for Advanced Cultural and Social Studies at the University of Erfurt.



Jutta Limbach

1966 doctorate in law, Freie Universität Berlin; 1972 Professor of Private Law, Freie Universität Berlin; 1989 to 1994 Senator for Justice in Berlin; 1994 to 2002 President of the German Federal Constitutional Court; 2002 to 2008 President of the Goethe-Institut.



Ludger Pries

1980 to 1985 study of sociology and social science at the universities of Bochum, Erlangen-Nuremberg and Puebla/Mexico; 1989 doctorate; 1989 to 2001 teaching and research at various universities in Europe and America; since 2001 Chair in Sociology at Ruhr-Universität Bochum, speaker of the “Migration and Ethnic Minorities” section at the German Sociological Association.



Young Researchers

The international scientific conference "Our Common Future" is the final event and highlight of two cooperation programmes. In each session of the conference, members of the Global Young Faculty ("GYF Fellows") and Our Common Future Fellows ("OCF Fellows") will present the results of their sub-groups' work or their individual research.

Global Young Faculty

The Global Young Faculty is an interdisciplinary network of around 100 young researchers at postdoctoral level in the Ruhr metropolitan area. Funded by Stiftung Mercator, they have the opportunity to present their solutions to current and future challenges of our globalized world and to collaborate with international experts.

Since November 2009 and over the course of the year 2010 the members of the Global Young Faculty have been working together in five groups: Climate, Technology, Economics, Health, and Culture and Society. The groups each consist of 10 to 25 scientists, all with different scientific backgrounds and expertise. The group members decide independently on the specific research topics and projects. Each working group receives its own budget, which may be used for workshops, conferences, excursions, publications etc.

The Global Young Faculty is an initiative of Stiftung Mercator, coordinated by the Institute for Advanced Study in the Humanities (KWI) in Essen. It is the contribution to the European Capital of Culture RUHR.2010 of these two institutions, the University Alliance Metropolis Ruhr (UAMR) and non-university research institutes. The Global Young Faculty is additionally supported by the Ministry of Innovation, Science, Research and Technology of North Rhine-Westphalia.

For further information:

www.global-young-faculty.de

Our Common Future Fellows

Global challenges should be approached by bridging different cultures, nations, disciplines and generations. To this end, the Volkswagen Foundation invited 100 early career researchers from all over the world to participate in the conference "Our Common Future". The diversity of their perspectives, experiences and questions will enrich and further the dialogue between generations and disciplines about the current and future challenges facing our increasingly globalized world.

In the course of 2010, these young researchers, known as "Our Common Future Fellows", were given the opportunity to pursue an intensive intellectual exchange with one another and with members of the Global Young Faculty both via the internet and at the midterm meetings of the Global Young Faculty's five working groups. This exchange of ideas was both a preparation for and a contribution to the conference "Our Common Future".

For further information:

www.ourcommonfuture.de





The Volkswagen Foundation is an independent, non-profit foundation under private law with its head office in Hannover. It is dedicated to the support of the humanities and social sciences as well as science and technology in higher education and research.

Since 1962 the Volkswagen Foundation has funded more than 29,300 projects with a total of over 3.6 billion euros. The money spent on grants is generated by investing the capital of the Foundation - currently some 2.3 billion euros.

The Volkswagen Foundation funds research projects in path-breaking areas and provides assistance to academic institutions wishing to improve the structural conditions for their work. In particular, the Foundation perceives its mission as supporting the upcoming generation of researchers and promoting interdisciplinary and international collaboration.

www.volkswagenstiftung.de



Deutsche Messe develops, plans and runs trade fairs and exhibitions in Germany and abroad. It has extensive expertise and experience in planning and executing around 100 trade fairs and exhibitions in Germany and abroad every year, involving 25,000 exhibitors, 2 million visitors and 15,000 journalists from over 100 different countries.

The main emphasis continues to be on flagship international trade fairs for capital goods, run by Deutsche Messe in Hannover. The aim of these trade shows is to represent the latest markets and highlight international market trends. They are also a forum for applications-oriented demonstrations of the latest technology, as well as new launches of cutting edge technologies and presentations of the latest research findings.

Apart from its expertise in the running of international trade fairs and the unique capacity of its exhibition centre, Deutsche Messe offers exhibitors an excellent range of quality services, ensuring the best possible support before, during and after the show.

www.messe.de



Stiftung Mercator is one of Germany's largest foundations. It initiates and funds projects that promote better educational opportunities in schools and universities.

In the spirit of Gerhard Mercator, it supports initiatives that embody the idea of open-mindedness and tolerance through intercultural encounters, encouraging the sharing of knowledge and culture.

The foundation provides a platform for new ideas to enable people - regardless of their national, cultural or social background - to develop their personality, become involved in society and make the most of the opportunities available to them. In this way it is committed to inspiring ideas. Stiftung Mercator takes an entrepreneurial, international and professional approach to its work.

It has a particular affinity with the Ruhr area, the home of its founding family.

www.stiftung-mercator.de



Hannover on the river Leine is the capital of the federal state of Lower Saxony (Niedersachsen), Germany. With a population of more than 500,000 inhabitants, the city is one of northern Germany's major political, economic and cultural centres. The Hannover fairground, following a series of extensions in preparation for Expo 2000, is the largest in the world and every year hosts important commercial expositions such as the Hannover Fair and the CeBIT.

One of the most famous and beautiful sights in Hannover are the Royal Gardens of Herrenhausen.

With its numerous museums and theatres, seven universities and colleges and a student population of 33,000, Hannover is also home to the arts and sciences, and certainly well worth a visit!

www.hannover.de



The Ruhr region is the European Capital of Culture 2010. As an unconventional "metropolis in the making", it is well on its way to becoming a new centre in Europe.

In line with the motto "Change through Culture - Culture through Change", 53 cities in the region joined forces. They are proud to be able to play host to all those who wish to experience the breathtaking change that has seen Europe's legendary coal and steel region become a new type of polycentric cultural metropolis.

RUHR.2010 GmbH is the organization responsible for preparing and implementing the cultural capital programme and its accompanying marketing and tourism activities. Along with its partners it supports the development of sustainable effective structures for the Ruhr Metropolis.

RUHR.2010 has brought together regional players from the areas of culture, politics and business to form a creative alliance. Their ambitious aim is to transform the Ruhr region into an important player in the future of Europe, and give the area a new and unique branding on the map of Europe.

www.ruhr2010.de

IMPRINT

Publisher

VolkswagenStiftung

Kastanienallee 35

30519 Hannover

Germany

Deutsche Messe AG

Messegelände

30521 Hannover

Germany

Stiftung Mercator GmbH

Huyssenallee 46

45128 Essen

Germany

Responsible for Content

Christiane Duwendag

Jens Rehländer

Hartwig von Saß

Editor

Marisa Klasen

Editorial Cooperation

Katja Ebeling

Sophia Regge

Dr Antje Robrecht

Dr Felix Streiter

Anke Vollmann

Graphic Design

A3.plus GmbH, Gütersloh

(www.a3plus.de)

Illustration

Ines Meyer, Gütersloh

Print

Druckerei Scholz GmbH,

Oelde

©VolkswagenStiftung

Deutsche Messe AG

Stiftung Mercator GmbH

Hannover/Essen,

11 October 2010

(Programme: Subject to Alterations)

Hannover

Venue

Exhibition Grounds Hannover

To give you an idea of just how big the home base of Deutsche Messe is, it offers 496,000 square metres of covered indoor space (i.e. over 5.3 million square feet), 58,000 square metres of open-air space, 27 halls and pavilions - making it the biggest exhibition centre in the world. Apart from the distinctive architecture of the Exhibition Center's halls, it boasts a number of other features, including the Convention Center with its 35 function rooms, glassed-in areas between halls, grassy park-like areas and "chill-out" zones, to guarantee a relaxed yet productive atmosphere.

Address

Deutsche Messe
Messegelände
30521 Hannover
Germany

www.messe.de

General Information

More information about the Hannover Exhibition Grounds and the city of Hannover is available at:

http://www.messe.de/homepage_e
<http://www.hannover.de/english/index.html>

Media Information

All sessions and evening events are open to the press. Journalists are kindly asked to obtain accreditation in advance from presse@stiftung-mercator.de and on the day of the event itself to register at the registration counter. Throughout the congress you will have work rooms at your disposal in which the latest information (press events, interview slots, speeches) will be on display each day.

Point of contact at the congress in Hannover will be:

Jens Rehländer, Head of Communication,
Volkswagen Foundation
Phone: +49 511-8381-380
Mobile: +49 172-453 98 13
Mail: rehlaender@volkswagenstiftung.de

Arrival

Here you can find out how to reach the Hannover Exhibition Center by car, train, mass transit and from the airport.

By car

From the north: Take motorway A7 towards Kassel/Hannover, take exit 55, signposted Altwarmbüchen, to motorway A37 (B3 Messe-Schnellweg) towards Hannover/Messe

From the east: Take motorway A2 towards Magdeburg/Hannover/Dortmund, take exit 47, signposted Kreuz Hannover-Buchholz, to motorway A37 (B3 Messe-Schnellweg) towards Hannover/Messe

From the south: Take motorway A7 towards Hannover/Hamburg, take exit 60, signposted Dreieck Hannover-Süd, to motorway A37 (B3 Messe-Schnellweg) towards Hannover/Messe

From the west: Take motorway A2 towards Hannover/Magdeburg/Berlin, take exit 46, signposted Hannover-Lahe, to motorway A37 (B3 Messe-Schnellweg) towards Hannover/Messe

Using a navigation system?

If you are using a navigation system to travel to the show, please enter the Hannover destination "Hermesallee". This is the name of the street which runs parallel to the northern perimeter of the Exhibition Grounds.

Public transport

From the city centre you can reach the Exhibition Grounds by tram/U-Bahn/suburban railway.

Entrance NORD:

From Hannover Main Station via stations Kröpcke, Aegidientorplatz, Altenbekener Damm, Bothmerstraße; tram line 8.

Up-to-the-minute details of ticket prices and sales are available on the ÜSTRA website www.uestra.de.

By air

Direct flights to Hannover Airport are available from numerous major European cities. Hannover can be reached by air from all parts of the world via Frankfurt, Munich, Amsterdam, Brussels, Istanbul, Paris and London. There are also charter flights and special flights to and from Hannover during our trade fairs.

To see a complete flight schedule please visit the website of Hannover Airport www.hannover-airport.de.

Suburban railway (S-Bahn) line S5 runs all year from the airport to Hannover main railway station. The S-Bahn station is located between Terminals B and C.

Underground (U-Bahn) line 8 runs from Hannover main railway station to the Exhibition Grounds, serving the North entrances. For this final leg of your journey, no additional ticket is necessary; just keep your S-Bahn ticket to show upon request.

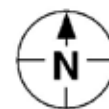
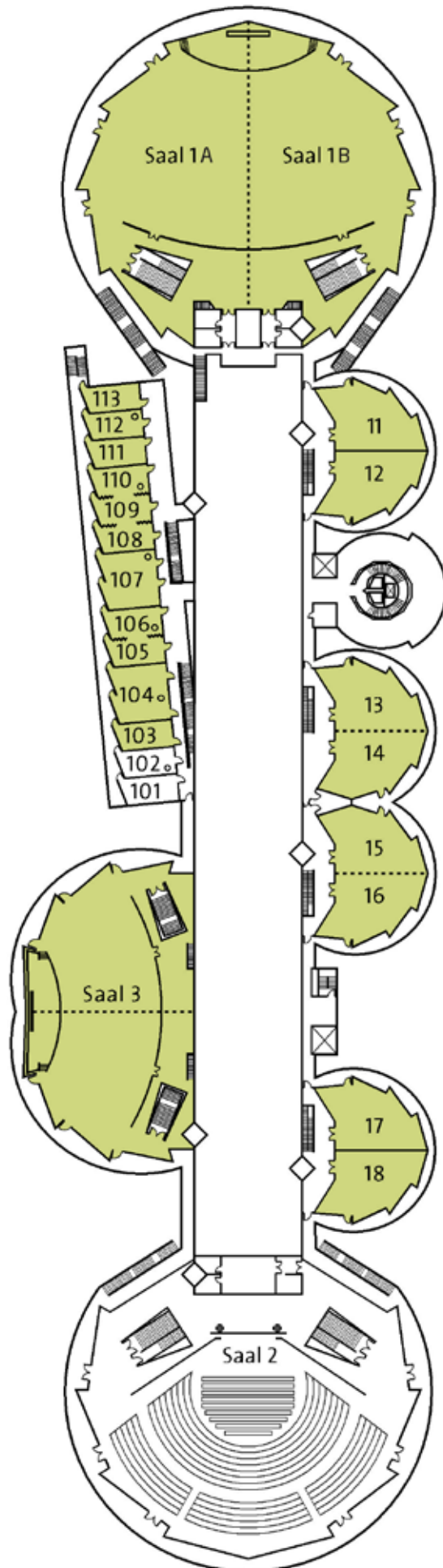

Legend

- 103** Journalists' work room
- 104** Media lounge
- 105/106** Smoking lounge
- 107** Internet café
- 108 - 110** Speakers' room

Essen

Venue

Philharmonic Concert Hall Essen (Philharmonie Essen)

The new home of the Essen Philharmonic Orchestra in the historic "Saalbau" building opened in 2004. The Philharmonic Concert Hall is located in the centre of Essen and is one of the numerous venues for the festive programme of the European Capital of Culture 2010.

Address

Philharmonie Essen
Huyssenallee 53
45128 Essen
Germany

www.philharmonie-essen.de

General Information

More information about the Philharmonic Concert Hall Essen, the city of Essen, and the Ruhr Metropolitan Area is available at:

www.philharmonie-essen.de
www.essen.de
www.ruhr-tourismus.de

Media Information

All sessions and evening events are open to the press. Journalists are kindly asked to obtain accreditation in advance from presse@stiftung-mercator.de and on the day of the event itself to register at the registration counter. Throughout the congress you will have work rooms at your disposal in which the latest information (press events, interview slots, speeches) will be on display each day.

Point of contact at the congress in Essen will be:

Marisa Klasen, Communication Manager,
Stiftung Mercator
Phone: +49 201 245 22 53
Mobile: +49 151-122 39 837
Mail: klasen@stiftung-mercator.de

Arrival

How to get to the Philharmonic Concert Hall/"Saalbau" building in Essen by car, train and plane:

By car

If you are arriving by car - regardless of whether you are coming from the A 40 motorway (exit: Essen-Zentrum), the A 42 motorway (exit: Kreuz Essen-Nord) or the A 52 motorway (exit: Essen-Rüttenscheid) - follow the signs to Essen-Zentrum and Philharmonie/Saalbau. You will find parking spaces directly in front of the Essen Philharmonic Concert Hall in the "Saalbau" car park and in the Philharmonic Concert Hall car park, both of which can be easily reached from "Huyssenallee".

Using a navigation system?

Saalbau multi-storey car park/Sheraton Hotel
Destination for satellite navigation system:
Huyssenallee 17 or 55, 45128 Essen
The daily parking rate is 12 euros.

Philharmonie multi-storey car park
(entrance directly on Huyssenallee)
Destination for satellite navigation system:
Huyssenallee 53, 45128 Essen
The daily parking rate is 15 euros.

Public transport

The Philharmonic Concert Hall can be reached by foot in a few minutes from the main Essen railway station. You can also take the bus, tram or train to the stations "Philharmonie/Saalbau" or "Aalto-Theater". The underground train U11 and the trams 101 and 107 stop directly in front of the buildings of the Essen Philharmonic Concert Hall. You will find your individual connection and the quickest way to the Philharmonic Concert Hall at

www.vrr.de or
www.evag.de.

By air

If you are flying, your destination is the Rhine-Ruhr airport Düsseldorf International. With over 500 take-offs and landings every day, it offers flight connections to over 170 cities in Germany and abroad.

Düsseldorf airport is only about 30 minutes by car from the Philharmonic Concert Hall/"Saalbau" building. You can also choose between four ICE lines (40, 45, 10 and 41) from Düsseldorf Airport railway station which will whisk you to Essen's main railway station in just 22 minutes. In addition to the commuter train (S1), three regional express trains (RE 1, 6 and 11) also go to the main Essen railway station.

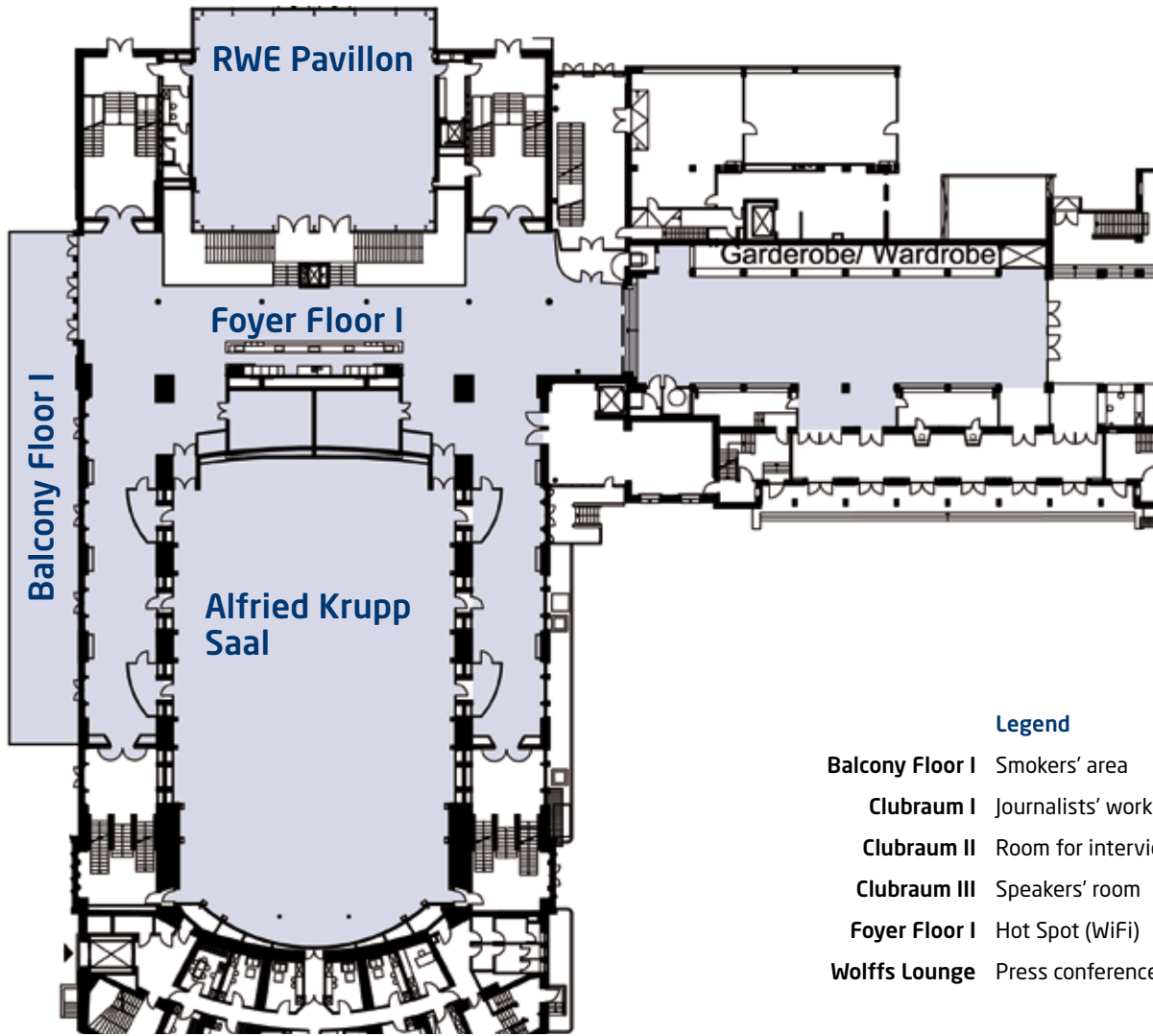

Legend

- Balcony Floor I Smokers' area
- Clubraum I Journalists' work room
- Clubraum II Room for interviews
- Clubraum III Speakers' room
- Foyer Floor I Hot Spot (WiFi)
- Wolffs Lounge Press conference room

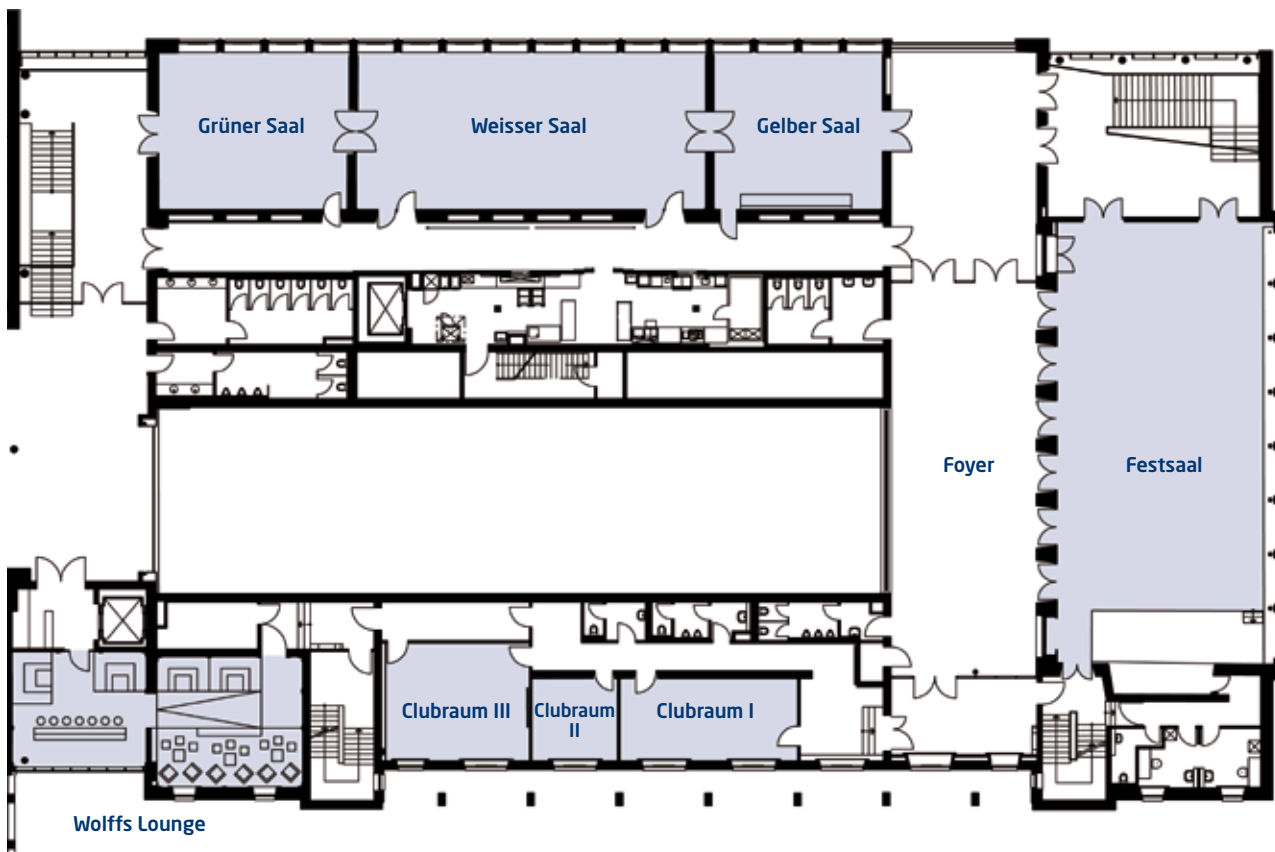



VolkswagenStiftung

Antje Robrecht, Project Manager,
mail: robrecht@volkswagenstiftung.de, phone: +49 511-8381-211

Jens Rehländer, Communication,
mail: rehlaender@volkswagenstiftung.de, phone: +49 511-8381-380

Address:

VolkswagenStiftung
Kastanienallee 35
30519 Hannover
Germany



Deutsche Messe
Hannover · Germany

Anke Vollmann, Congress Manager,
mail: anke.vollmann@messe.de, phone: +49 511-89-31257

Hartwig von Saß, Communication,
mail: hartwig.vonsass@messe.de, phone: +49 511-89-31010

Address:

Deutsche Messe AG
Messegelände
30521 Hannover
Germany



Stiftung
Mercator

Felix Streiter, Project Manager,
mail: felix.streiter@stiftung-mercator.de, phone: +49 201-24522-37

Marisa Klasen, Communication,
mail: marisa.klasen@stiftung-mercator.de, phone: +49 201-24522-53

Address:

Stiftung Mercator
Huyssenallee 46
45128 Essen
Germany



Annina Lottermann, Contact Person,
mail: annina.lottermann@kwi-nrw.de, phone: +49 201-7204-252

Marc Oliver Hänig, Communication,
mail: marc.oliver.haenig@ruhr2010.de, phone: +49 201-888-2099

Address:

RUHR.2010 GmbH
Brunnenstraße 8
45128 Essen
Germany

Registration Office:

Our Common Future
c/o Deutsche Messe AG
Messegelände
30521 Hannover
Germany

Phone: +49 511-89-30993

Fax: +49 511-89-31658

Mail: our-common-future@messe.de

www.ourcommonfuture.de

